

SPECIFICATION
MATERIAL
 Insulator: PBT, rated UL94V-0
 Contacts: Brass (standard)
 Shell: Steel
 Rivet, Boardlock: Copper alloy
CONTACT PLATING
 Underplate: 50u" Nickel
 Contact area: 1u"~30u" selective gold
 Solder tails area: 100u" Tin/Lead
 Shell: Copper/Nickel/Tin special anti-rust plating
ELECTRICAL
 Operation Voltage: 250 VAC max.
 Current rating: 3 Amps max.
 Contact resistance: 15 mohms max @ 500 VDC
 Dielectric withstanding voltage: 1000 VAC / minute
 Operating temperature: -55°C to +105°C
 Part no.

102 A E 44 M G P A A A 1
 1 2 3 4 5 6 7 8 9 10 11

- 1.SERIES NO.
102 = D-SUB HDD SOLDER MACHINED PIN
(D-SUB 焊線高密度 車針)
- 2.TYPE: A = Standard
- 3.ENVIRONMENT PROTECTION
MATERIA
E = ROHS環保料件
- 4.CONTACT NUMBER:
44 = 44 PIN
- 5.CONTACT TYPE:
M = MALE (公)
- 6.CONTACT AREA PLATING:
G = GOLD FLASH (全金)
R = 3"u GOLD (全金)
A = 5"u GOLD (全金)
C = 15"u GOLD (全金)
D = 30"u GOLD (全金)
- 7.SHELL PLATING:
P=TIN+DIMPLE(鍍錫壓花)
- 8.PROCESS OPTION:
A=THRU. HOLE (光孔)
- 9.PARTS OPTION:
A=NON ACCESSORIES(無螺絲附件)
- 10.CONTACT INSERTING OPTIN:
A=FULLY LOADED(滿針)
- 11.INSULATOR COLOR:
1=WHITE (白色)
2=BLUE (藍色)
3=BLACK (黑色)

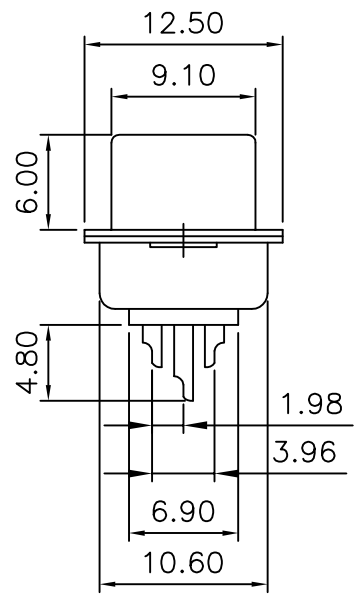
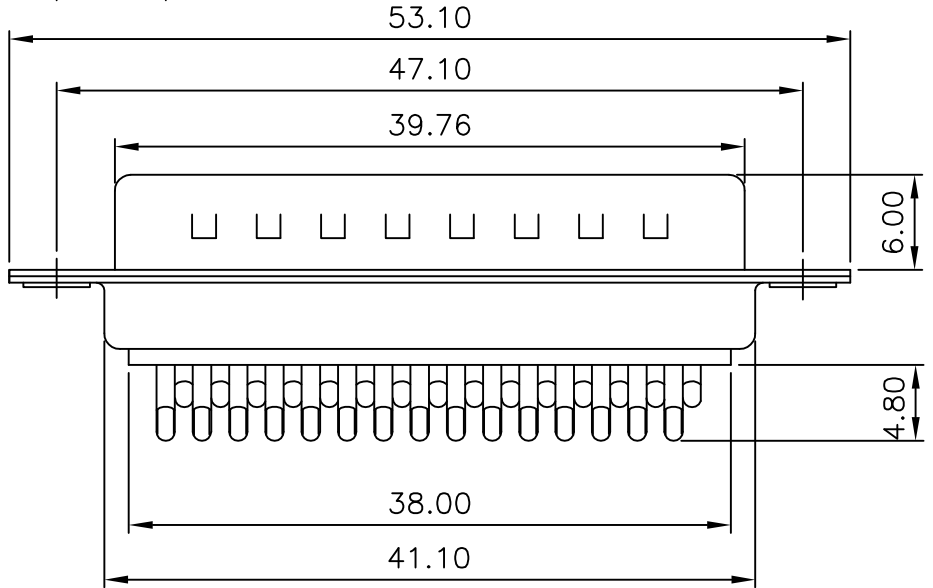

UNLESS OTHERWISE SPECIFIED TOLERANCE	
ANG.	±5°
0.	±0.5
.0	±0.3
.00	±0.2
SCALE: AS SHOWN	UNIT: mm

亮泰 (中国) 有限公司
 Lightany (China) Co., Ltd.

ECN-20040707001(TONY)	07/07/04	APPROVED TONY	07/07/04	PRODUCT NO. 102AE44MGPA001
REV.	DESCRIPTION	DATE	SIZE A4	REV. A
1	2	3	4	5
6	7	8	9	10

DRAWN	AVA	07/07/04	DRAWN NAME: D-SUB HDD SOLDER MACHINED(HDD 焊線車針)
CHECKED	JUDY	07/07/04	44PIN, MALE(公), 全金, 光孔, 鍍錫壓花
FILE NAME: 102AE44MGPA001			