

SPECIFICATION
MATERIAL
 Insulator: PBT, rated UL94V-0
 Contacts: Brass
 Shell: Steel
 Rivet, Boardlock: Copper alloy
CONTACT PLATING
 Contact area: Gold flash
 Solder tails: 100u" Tin over 40u" Nickel
ELECTRICAL
 Operation Voltage: 250 VAC max.
 Current rating: 3 Amps max.
 Contact resistance: 15 mohms min @ 500 VDC
 Dielectric withstanding voltage: 1000 VAC / minute
 Operating temperature: -55°C to +105°C
 Part no.

104 A E 78 M G P H E A 1
 1 2 3 4 5 6 7 8 9 10 11

- SERIES NO.
104 = D-SUB HIGH DENSITY PCB STRAIGHT MACHINED PIN (D-SUB 高密度 180度 PCB 專針)
- TYPE: A = Standard
- ENVIRONMENT PROTECTION
MATERIAL:
E = RoHS 環保材料
- CONTACT NUMBER:
78 = 78 PIN
- CONTACT TYPE:
M = MALE (公)
- CONTACT AREA PLATING:
G = GOLD FLASH (全金)
R = 3"u GOLD (全金)
A = 5"u GOLD (全金)
C = 15"u GOLD (全金)
D = 30"u GOLD (全金)
- SHELL PLATING:
P = TIN+DIMPLE (鍍錫壓花)
- PROCESS OPTION: DIM "X" & "Y"
H = 6.0mm Boardlock rivet (6.0mm 180度(Z) 卯釘)
FOR 4.80mm (X = 6.00 mm, Y = 4.00mm)
I = 7.0mm Boardlock rivet (7.0mm 180度(Z) 卯釘)
FOR 4.80mm (X = 7.00 mm, Y = 3.00mm)
- PARTS OPTION
E = REAR Rivet (卯後鍍殼, 無附件螺絲)
F = REAR Rivet+Loose screws (卯後殼, 附5.0*10.0螺絲)
H = REAR Rivet+Loose screws (卯後殼, 附4.8*11.8螺絲)
J = REAR Rivet+Loose screws (卯後殼, 附5.8*12.0螺絲)
G = REAR Rivet+Fixed HEX-screws (卯後殼, 鑽5.0*10.0螺絲)
I = REAR Rivet+Fixed HEX-screws (卯後殼, 鑽4.8*11.8螺絲)
K = REAR Rivet+Fixed HEX-screws (卯後殼, 鑽5.8*12.0螺絲)
- CONTACT INSERTING OPTION
A = Fully loaded (滿針)
- INSULATOR COLOR
1 = WHITE (白色)
2 = BLUE (藍色)
3 = BLACK (黑色)

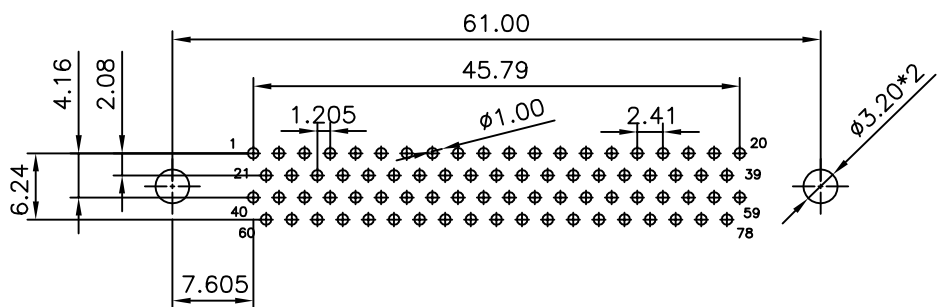
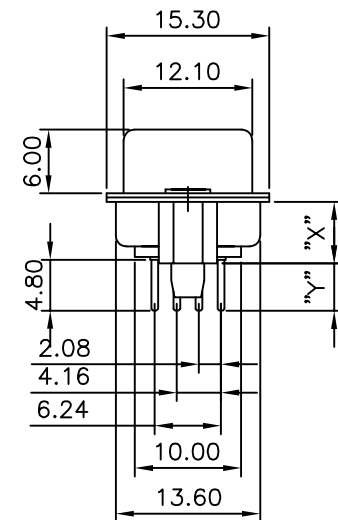

RECOMMENDED P.C.B LAYOUT (TOP VIEW)
 TOLERANCES: ±0.10mm

UNLESS OTHERWISE SPECIFIED TOLERANCE		亮泰 (中国) 有限公司 Lightany (China) Co., Ltd	
ANG.	±5°		
0.	±0.5		
.00	±0.3		
SCALE: As show	UNIT: mm	DRAWN NAME:	
DRAWN AVA	07/07/04	D-SUB HDD PCB STRAIGHT MACHINED (無附件 180度 專針) 78PIN, MALE (公), 全金 G/F, 6.0mm (Z) 卯釘, 卯後殼	
CHECKED JUDY	07/07/04	PRODUCT NO. 104AE78MGPHEA1	
APPROVED TONY	07/07/04	FILE NAME: 104AE78MGPHEA1	

REV.	DESCRIPTION	DATE
A	ECN-20040707001 (TONY)	07/07/04